

**SITE PLAN**

AT HOL. NO. = 3 CRIPER BYE LANE (SOUTH), KONNAGAR, HOOGHLY, P.S. =  
 UTTARPARA, DIST. = HOOGHLY, P.O. = KONNAGAR, WARD NO. = 12. UNDER  
 KONNAGAR MUNICIPALITY, SUB DIVISION SERAMPORE, WEST BENGAL, SCALE = 1:200.  
 AT R.S. PLOT NO. = 1694, R.S. KH. NO. = 3037, L.R. PLOT NO. = 3245, L.R. KH. NO. = 6274.  
 J.L. NO. = 7, MOUZA = KONNAGAR.

**AREA OF LAND = 6 KH - 11CH - 21 SQ.FT. = 449.26 SQ.M.**  
 PRO. GROUND FLOOR COVD. AREA = 287.16 SQ.M.  
 PRO. FIRST FLOOR COVD. AREA = 287.16 SQ.M.  
 PRO. SECOND FLOOR COVD. AREA = 287.16 SQ.M.  
 PRO. THIRD FLOOR COVD. AREA = 287.16 SQ.M.  
 PRO. TOTAL FLOOR AREA = 1148.64 SQ.M.  
 PRO. TOTAL OPEN AREA = 162.10 SQ.M.  
 PRO. PORTION SOWN IN **RED** HATCH.

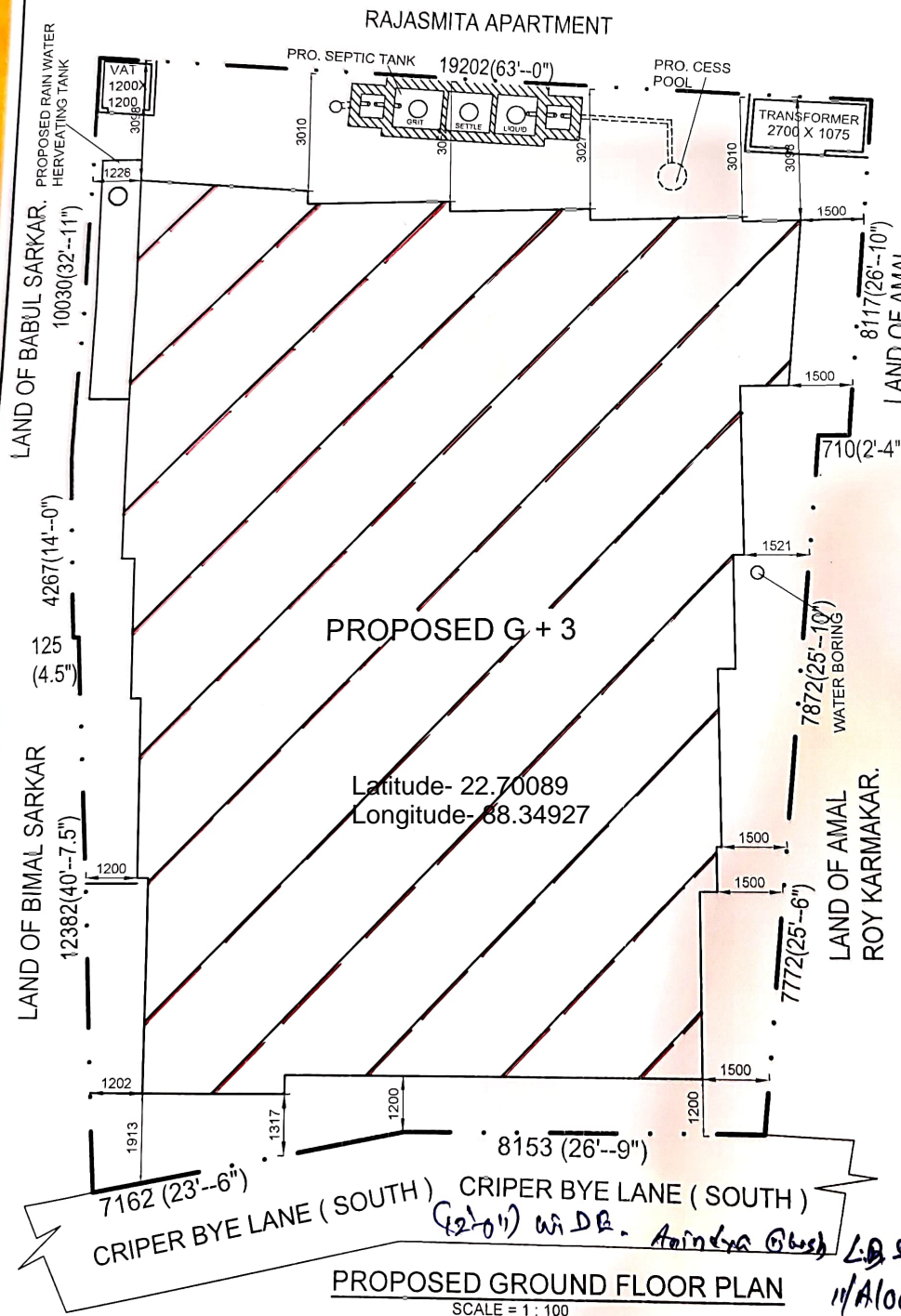
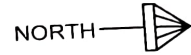

*Amal Kanti Banerjee*  
*Syamal Kanti Banerjee*  
*Debabrata Mukherjee*  
*Suman Kanti Bandyopadhyay*  
*Shipra Bhattacharya*

SIG. OF OWNERS :

*Surosrita Pal*  
**Surosrita Pal**  
 L.B.S. No. - 11/004/K.M./P.W.D  
 2B/1/A, S.C.Chatterjee Street  
 Konnagar, Hooghly

**PROPOSED GROUND FLOOR PLAN**  
 SCALE = 1 : 100  
 11/A/1004,

SIG. OF L. B. S. :